



## FUSELAGE

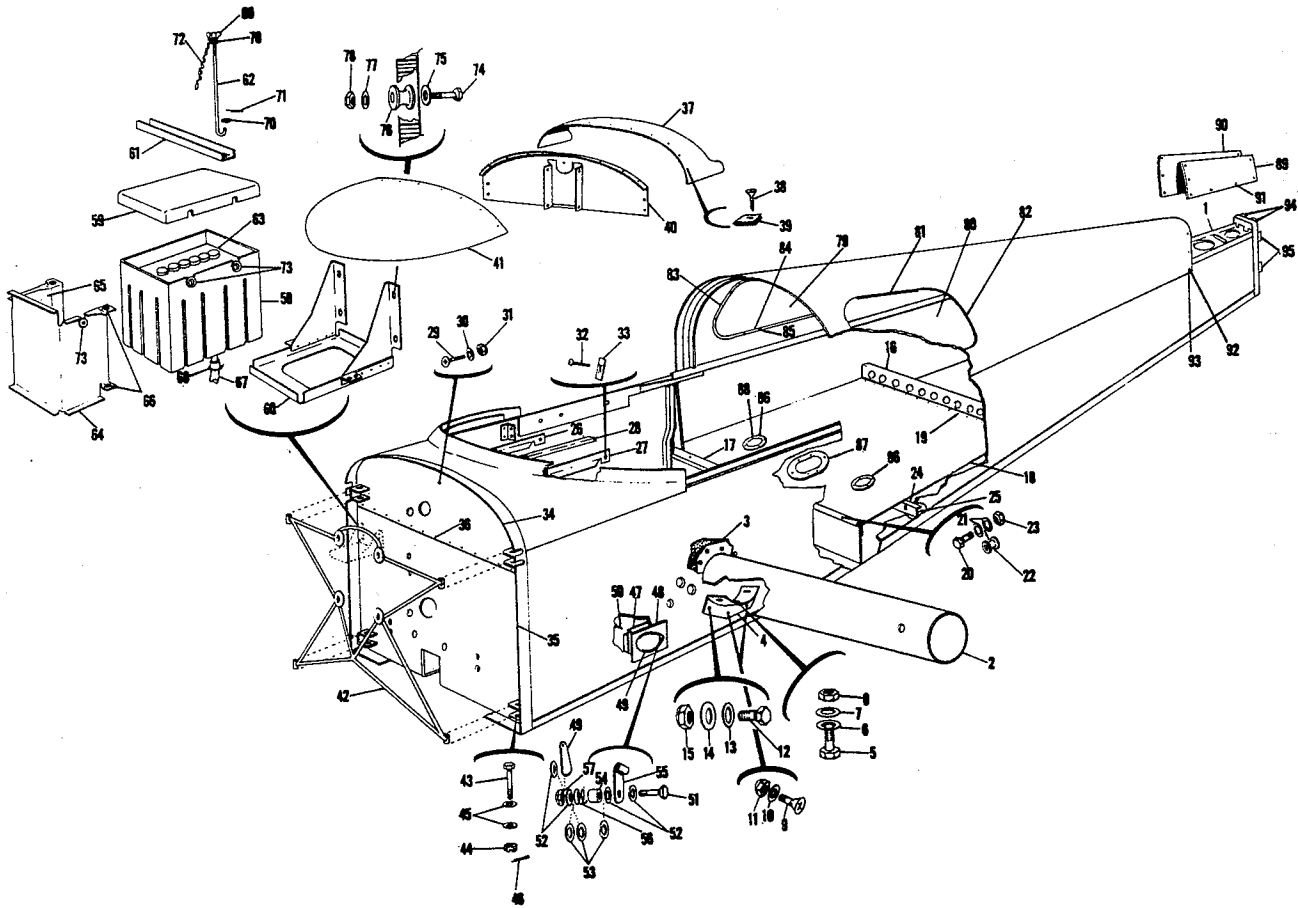

FIGURE 1: FUSELAGE INSTALLATION



FIGURE AND INDEX NO.	PART NUMBER	DESCRIPTION							UNITS PER ASSY	USABLE ON CODE
		1	2	3	4	5	6	7		
1-		FUSELAGE ASSY								
-1	102297-501	Fuselage Assy - Bonded - - - - -							NP	
-2	102310-501	Spar Assy - Inboard- - - - -							1	
		Attaching Parts							1	
-3	102031-1	Support Assy - - - - -							1	
-4	102031-2	Support Assy - - - - -							1	
		Attaching Parts								
-5	AN6-7A	Bolt - - - - -							6	
-6	AN960-616L	Washer - - - - -							12	
-7	AN960D616	Washer - - - - -							12	
-8	MS20364-624	Nut- - - - -							12	
-9	NAS222-18	Screw- - - - -							4	
-10	AN960-416	Washer - - - - -							4	A
-11	MS20364-428	Nut- - - - -							4	
-12	AN4-11A	Bolt - - - - -							12	
-13	AN960-416	Washer - - - - -							16	
-14	901035-1	Washer - - - - -							12	
-15	MS20364-428	Nut- - - - -							16	
		- - - * - - -								
-16	102302-1	Support - Baggage Floor Aft- - - - -							1	
-17	102303-1	Support - Baggage Floor Fwd- - - - -							1	
-18	102304-1	Floor - Baggage- - - - -							1	
-19	102291-1	Panel - Aft- - - - -							1	
-20	AN3-10A	Bolt - - - - -							6	
-21	AN960-10	Washer - - - - -							6	
-22	AES201-1	Spacer - - - - -							6	
-23	MS20364-1032	Nut- - - - -							6	
		- - - * - - -								
-24	102356-1	Bulkhead - - - - -							1	
-25	102356-2	Clip - - - - -							2	
-26	102342-2	Angle- - - - -							1	
-27	102342-501	Radio Support Assy - - - - -							1	
-28	102341-1	Instrument Panel Brace - - - - -							1	
-29	AN526-1032R16	Screw- - - - -							1	
-30	AN960-10L	Washer - - - - -							1	
-31	MS20364-1032	Nut- - - - -							1	
-32	AES1021Z6-6B	Screw- - - - -							8	
-33	NAS395-2-3	Nut- - - - -							8	
-34	102309-2	Firewall - - - - -							1	
-35	102039-1	Firewall - - - - -							1	
-36	1601-0410	Rivet (Avdel)- - - - -							53	
-37	102338-501	Glare Shield Assy- - - - -							1	
-38	AES1026-8B	Screw- - - - -							6	
-39	NAS395-4-1	Nut- - - - -							6	

(Continued on next page)



FIGURE AND INDEX NO.	PART NUMBER	DESCRIPTION	1 2 3 4 5 6 7							UNITS PER ASSY	USABLE ON CODE
		FUSELAGE ASSY (Continued)									
-40	102312-1	Instrument Panel - - - - -									1
	102340-1	Cover - Instrument Panel - - - - -									1
	102315-1	Base Panel Cover - - - - -									1
-41	102355-1	Deck - - - - -									1
	4303-4	Seal (Sterling Alderfer) - - - - -									1
-42	501110-501	Engine Mount Assy- - - - -									1
-43	AN6-21	Bolt - - - - -									4
-44	AN310-6	Nut- - - - -									4
-45	AN960-616	Washer - - - - -									8
-46	MS24665-283	Cotter Pin - - - - -									4
-47	406003-1	Air Vent Grille- - - - -									2
		Attaching Parts									
-48	406002-3	Seal - - - - -									2
-49	406003-2	Air Vent Cover - - - - -									2
-50	AES1021A6-8	Screw- - - - -									4
-51	A3-13A	Bolt - - - - -									2
-52	AN936A10	Washer - - - - -									8
-53	AN960-416	Washer - - - - -									6
-54	466003-3	Spacer - - - - -									2
-55	406003-5	Lever (LH) - - - - -									1
	406003-4	Lever (RH) - - - - -									1
-56	LC-022D-1	Spring (Lee Spring Co.)- - - - -									2
-57	MS20364-1032	Nut- - - - -									2
		- - - * - - - -									
-58	402012-4	Battery Box- - - - -									1
-59	402012-501	Cover Assy - - - - -									1
-60	402013-501	Battery Support Assy - - - - -									1
-61	402013-4	Tie Down - - - - -									1
-62	402013-5	Tie Down Rod - - - - -									2
-63	6-GCAB-9	Battery (Gill) - - - - -									1
	402015-501	Heat Shield Assy - - - - -									1
-64	402015-1	Shield - - - - -									1
-65	402015-2	Liner- - - - -									1
-66	MS35489-6	Grommet- - - - -									4
-67	402014-1	Tube - - - - -									1
-68	A-10	Clamp- - - - -									1
-69	MS35426-14	Wing Nut - - - - -									2
-70	AN960-416	Washer - - - - -									4
-71	MS24665-132	Cotter Pin - - - - -									2
-72	MS20995C-32	Lock Wire- - - - -									A/R
-73	MS35489-100	Grommet- - - - -									3
-74	AN3-10A	Bolt - - - - -									4
-75	AN970-3	Washer - - - - -									4
-76	AES201-1	Spacer - - - - -									4
-77	AN960-10	Washer - - - - -									4
-78	MS20364-1032	Nut- - - - -									4

(Continued on next page)



FIGURE AND INDEX NO.	PART NUMBER	DESCRIPTION							UNITS PER ASSY	USABLE ON CODE	
		1	2	3	4	5	6	7			
		FUSELAGE ASSY (Continued)									
-79	102322-1	Window	-	-	-	-	-	-	-	1	
-80	102322-2	Window	-	-	-	-	-	-	-	1	
	7402	Seal - Felt (Johns Manville)	-	-	-	-	-	-	-	2	
-81	102306-2	Retainer	-	-	-	-	-	-	-	2	
-82	102308-2	Retainer (RH)	-	-	-	-	-	-	-	1	
	102308-1	Retainer (LH)	-	-	-	-	-	-	-	1	
-83	102307-1	Retainer (LH)	-	-	-	-	-	-	-	1	
	102307-2	Retainer (RH)	-	-	-	-	-	-	-	1	
-84	102306-1	Retainer	-	-	-	-	-	-	-	2	
		Attaching Parts									
-85	AES1021A6-4	Screw	-	-	-	-	-	-	-	24	
		- - - *	-	-	-	-	-	-	-		
-86	AES-300	Inspection Plate	-	-	-	-	-	-	-	2	
-87	AES-301-1	Inspection Plate	-	-	-	-	-	-	-	1	
		Attaching Parts									
-88	SA-4	Stud Button (Weckessor)	-	-	-	-	-	-	-	14	
		- - - *	-	-	-	-	-	-	-		
-89	103012-1	Cover	-	-	-	-	-	-	-	1	
-90	103012-2	Cover	-	-	-	-	-	-	-	1	
		Attaching Parts									
-91	AN526-832-R8	Screw	-	-	-	-	-	-	-	14	
-92	NSS680A08	Nut Plate	-	-	-	-	-	-	-	14	
-93	1204-0306	Rivet	-	-	-	-	-	-	-	28	
		- - - *	-	-	-	-	-	-	-		
-94	102316-2	Bracket	-	-	-	-	-	-	-	2	
-95	102316-1	Bracket	-	-	-	-	-	-	-	4	
		(A - - AA1-0104 and up)									